

86 Old Church Road
Chingford
E4 8BX

T: 0208 524 7444
www.kings-group.net



Aldriche Way, E4 9LX



By Auction £170,000 Leasehold



FOR SALE BY ONLINE AUCTION. Starting Bid £170,000. Terms and conditions apply.

Kings of Chingford in Partnership with Pattinsons are delighted to offer to the market this newly refurbished 2 bedroom flat.

Situated in close proximity to Highams Park Train Station and all the amenities you need on your doorstep, this property provides a superb opportunity for first time buyers or investors.

Comprised of two double bedrooms and a newly fitted kitchen complete with white, high gloss base and eye level units as well as an integrated oven, Other features include, gas central heating, double glazing and balcony.

Call our prominent North or South Chingford office now to arrange your viewing and avoid disappointment.



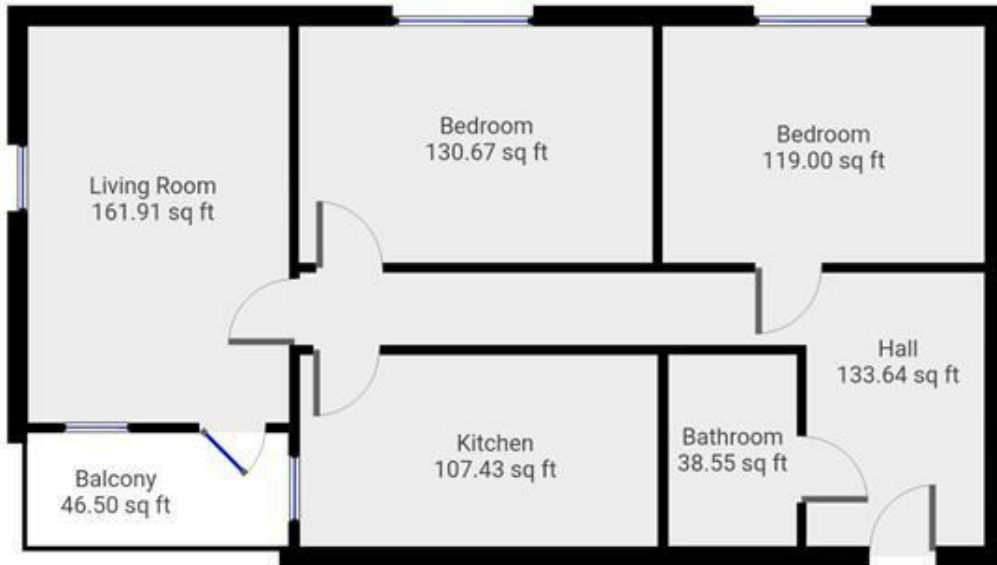

THIS FLOORPLAN IS PROVIDED WITHOUT WARRANTY OF ANY KIND. SENSOPIA DISCLAIMS ANY WARRANTY INCLUDING, WITHOUT LIMITATION, SATISFACTORY QUALITY OR ACCURACY OF DIMENSIONS.

86 Old Church Road, Chingford, E4 8BX

T: 0208 524 7444
www.kings-group.net



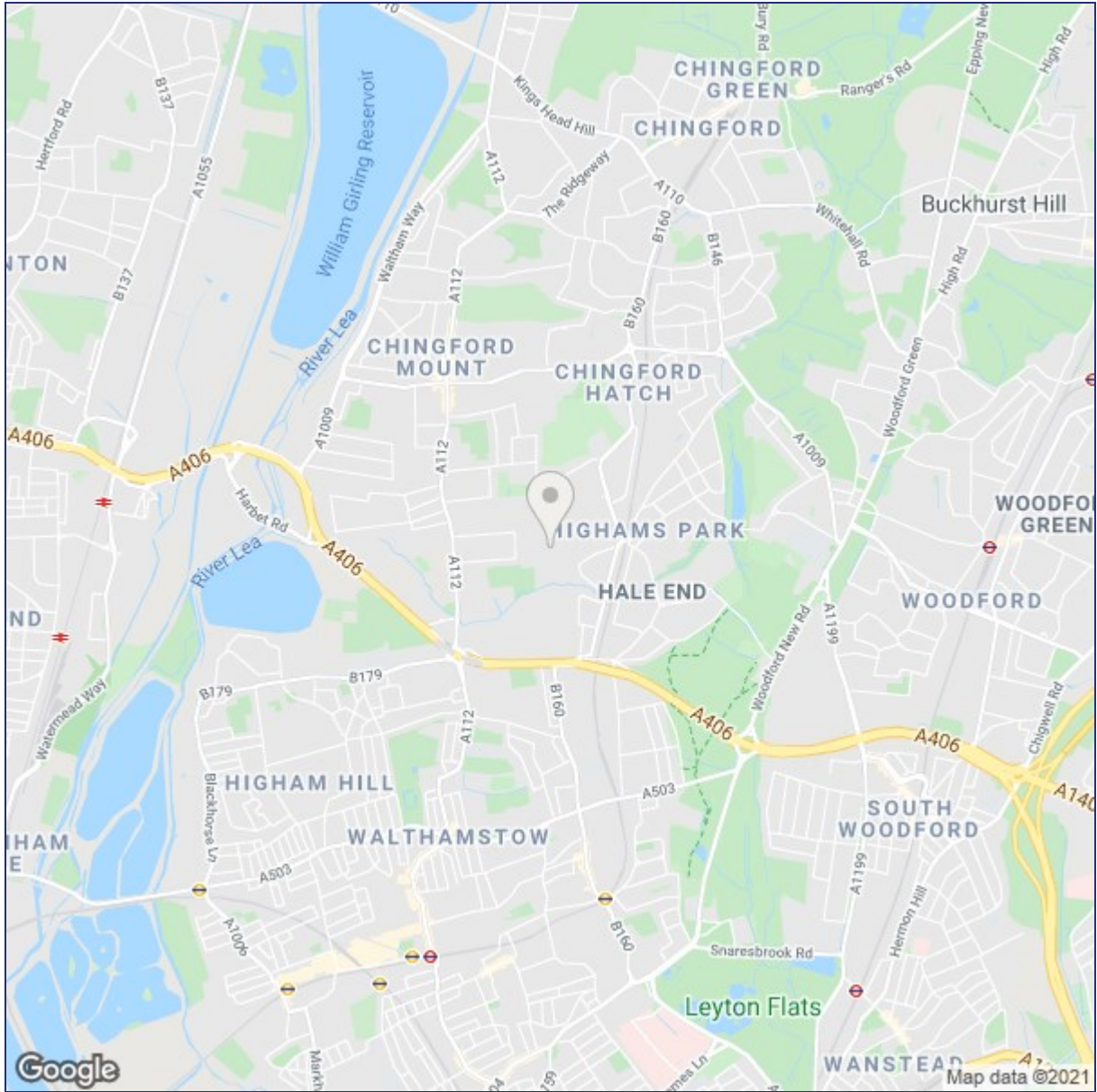

Energy Efficiency Rating		Environmental Impact (CO ₂) Rating	
Current	Potential	Current	Potential
Very energy efficient - lower running costs (92 plus) A (81-91) B (69-80) C (55-68) D (39-54) E (21-38) F (1-20) G Not energy efficient - higher running costs		Very environmentally friendly - lower CO ₂ emissions (92 plus) A (81-91) B (69-80) C (55-68) D (39-54) E (21-38) F (1-20) G Not environmentally friendly - higher CO ₂ emissions	
	59		59
England & Wales EU Directive 2002/91/EC		England & Wales EU Directive 2002/91/EC	

("These details are correct at time of going to press").

THE PROPERTY MISDESCRIPTIONS ACT 1991. The agent has not tested any apparatus, equipment, fixtures or services and so cannot verify that they are in working order, or fit for the purpose. References to the Tenure of a property are based on information supplied by the vendor. The agent has not had sight of the Title documents. A buyer is advised to obtain verification from their Solicitor or Surveyor.

